



# THE MARNHULL MESSENGER



Original illustration by George Cox

PAGE 13



PAGE 12

WANT TO BE INVOLVED IN THE PANTOMIME?

HAPPY 90TH BIRTHDAY NORVAL!!

PAGE 12

A SUMMER OF SUNFLOWERS

PAGE 5



THE SURGERIES

What's new from our local doctors surgeries

PAGE 14



IN OUR CHURCHES

All the latest news from the churches

PAGE 16



OUR SCHOOLS

See what the schools are up to

# SUPER HERO TECH SOLUTIONS



**WEBSITES**

**NEW  
TECH REPAIRS**

**APPS**

**SEO**

**3D PRINTING**

**MARKETING**



**Dorset Tech**  
Part of **Honest** Tech Group

GILLINGHAM HIGH STREET  
[WWW.DORSET.TECH](http://WWW.DORSET.TECH)



## WELCOME TO YOUR MARNHULL MESSENGER

**CHRIS RYU**  
Messenger Editor

### October 2022 - Issue 128

Welcome back! Bit of a busier issue this time, thank you for sending in all these great articles - last month was just a blip.

I've had an enquiry from a generous villager potentially willing to take on the Editor role... who knows, this could be one of my last issues. How will you ever cope without seeing my pink hair and reading my intro..? I'm sure you'll survive!

My life's still manic, focusing on business recovery really. We're busier than ever, but getting people to pay their bills is harder than ever. We finished phase 1 of the office expansion and after long delays it looks like we finally agreed a deal for the office move.

I'm writing this during the period of mourning for HM The Queen and it's certainly a weird time. So much uncertainty, so many suspended meetings and there's a very sombre mood around the village. A lot of us have only ever experienced her rein and after Brexit, Covid and an energy crisis, it's going to be an even bigger shock to people's lives. Let's all take a minute to appreciate her flawless life of service and think of her family at this challenging time.

Long live King Charles III.

### NEW EDITOR STILL REQUIRED

This paragraph almost seems silly now, but we're still looking for a new Editor. No specific experience needed, just a good level of computer literacy.

### VILLAGE HELP

**NORCAT** - Bookings 10am - 3pm - 01258 472164

**Dial-a-Ride - Major & Immediate Emergencies Only** - 07900 261182

**Marnhull Village Care Car Service:**

Ann Davis-Penson - tel: 07434 638485 or 01258 820456.

This is offered for door to door transport for the elderly, disabled and unemployed for essential trips with a set scale of modest donations.

## SUBMIT YOUR EVENTS INTO A LIVE CALENDAR

On the messenger website and they'll be added to the printed one when it returns in the near future

[www.marnhullmessenger.org.uk](http://www.marnhullmessenger.org.uk)

### DEADLINE FOR NEXT ISSUE

**MID-DAY 14th October**

E-mail all texts, announcements and other requests to:  
[editor@marnhullmessenger.org.uk](mailto:editor@marnhullmessenger.org.uk)

### MARNHULL MESSENGER CONTACT DETAILS

#### EDITOR:

Chris Ryu - [editor@marnhullmessenger.org.uk](mailto:editor@marnhullmessenger.org.uk)  
01258 808577 (option 4)

#### WEBMASTER:

Chris Ryu - as above

#### ADVERTISING:

Rosie Gall - [rosiegall1@gmail.com](mailto:rosiegall1@gmail.com)

#### TREASURER:

Bill Shannon - [treasurer@marnhullmessenger.org.uk](mailto:treasurer@marnhullmessenger.org.uk)  
01258 820890

#### CIRCULATION:

Catherine & Mark Turner - [circulation@marnhullmessenger.org.uk](mailto:circulation@marnhullmessenger.org.uk)

#### CHAIRMAN:

Ian Gall - [chairman@marnhullmessenger.org.uk](mailto:chairman@marnhullmessenger.org.uk)  
01258 820484

#### ADMINISTRATOR:

Fiona Nelson - [administrator@marnhullmessenger.org.uk](mailto:administrator@marnhullmessenger.org.uk)  
01258 821036

**These contact details are to be used in relation to the publication of the Marnhull Messenger ONLY**

### MARNHULL MESSENGER WEBSITE

#### WHO DO I CONTACT?

Any amendments or proposals for new pages in the messenger web site should be made to:

Chris Ryu Email: [editor@marnhullmessenger.org.uk](mailto:editor@marnhullmessenger.org.uk)

### MARNHULL MESSENGER DELIVERIES

It takes about 40 people, all of whom are volunteers, to collate and deliver The Marnhull Messenger to every home and business in the village. We are extremely grateful to this dedicated team, without whom the magazine simply would not flourish.

Whilst we always aim to deliver the magazine by the 1st of the month, from time to time illness, family commitments and a myriad of other personal issues can sometimes get in the way, resulting in the occasional late delivery. Recently, there have been a few complaints from villagers, because they felt their copy of The Marnhull Messenger was delivered late.

It might be worth pointing out that if it is essential to you to receive the Marnhull Messenger by a particular date and it hasn't arrived, then the Church, the two pubs and all the businesses in the village have spare copies available.

Ian Gall – Chairman, The Marnhull Messenger Steering Group.

#### Disclaimer

The opinions expressed in the articles and on the pages of the Marnhull Messenger are not necessarily those of the Marnhull Messenger. All the dates and details are as supplied by the contributing organisations. The Marnhull Messenger is not responsible for errors or omissions, accuracy of the content, nor the failure of any published event to go ahead. The letters and articles published in this magazine are accepted in good faith and the views expressed therein are not necessarily the views of the Messenger Steering Committee, whose decisions on publication are delegated to the Editor and are final.

This publication is provided for your use "as is" without warranty of any kind, either expressed or implied; inclusion of an advertisement for an event or service does not imply that they are endorsed by the Marnhull Messenger. The Marnhull Messenger will take all reasonable precautions to ensure that the content is socially and morally acceptable.

#### Privacy Policy

The Marnhull Messenger respects the privacy of organisations and persons who submit information for publication. Personal details, including photographs, will only be published if approved and submitted by organisations or individuals. No personal details will be given out or sold to any third parties, whether individuals, organisations or companies.

**ANNUAL DIARY 2022**

All events are held at the Village Hall unless otherwise stated.

**OCTOBER**

- 1st - Tony Letts @20:00 British Legion
- 3rd - Qigong & Tai Chi @13:00 Methodist Hall
- 3rd - Bingo @19:00 British Legion
- 4th - Bridge Club @14:00 Methodist Hall
- 6th - Craft Club @10am Methodist Hall
- 8th - The Originals@20:00 British Legion
- 10th - Qigong & Tai Chi @13:00 Methodist Hall
- 10th - Women's Institute - Hedgehogs in Need, Jeanette Hampstead @19:30
- 11th - Bridge Club @14:00 Methodist Hall
- 11th - Curious Plant Stories from around the World @19:30
- 12th - Tea with Friends meeting @14:30 Methodist Hall
- 13th - Marnhull Amblers - Short Walk - approx 3 miles @10am
- 14th - The Marnhull Autumn Charity Quiz 2022 @19:00
- 15th - Bill Shannon's Soul & Motown Disco @20:00 British Legion
- 17th - Qigong & Tai Chi @13:00 Methodist Hall
- 17th - Bingo @19:00 British Legion
- 18th - Bridge Club @14:00 Methodist Hall
- 18th - Wilder Gardening - The joy of making space for nature - Clive Whitbourn @19:30 Methodist Hall
- 21st - Marnhull Community Café @10am
- 22nd - Rip It Up @20:00 British Legion
- 23rd - A Summer of Sunflower Charity Art Exhibition & Sale @13:00
- 24th - Qigong & Tai Chi @13:00 Methodist Hall
- 25th - Bridge Club @14:00 Methodist Hall
- 27th - Marnhull Ramblers - Long Walk - 4-7 miles @10am
- 29th - Stage One @20:00 British Legion
- 31st - Qigong & Tai Chi @13:00 Methodist Hall

31st - Bingo @19:00 British Legion

**NOVEMBER**

- 1st - Qigong & Tai Chi @13:00 Methodist Hall
- 1st - Bridge Club @14:00 Methodist Hall
- 3rd - Craft Club @10am Methodist Hall
- 5th - Electric Vehicle Show @10am
- 7th - Qigong & Tai Chi @13:00 Methodist Hall
- 8th - Bridge Club @14:00 Methodist Hall
- 8th - Building a Christmas Display The Gold Club @19:30
- 9th - Tea with Friends meeting @14:30 Methodist Hall
- 10th - Marnhull Amblers - Short Walk - approx 3 miles @10am
- 14th - Qigong & Tai Chi @13:00 Methodist Hall
- 14th - Bingo @19:00 British Legion
- 14th - Women's Institute - Race to Scotland in a Tub-sized Dinghy, Ken Fowler @19:30
- 15th - Bridge Club @14:00 Methodist Hall
- 18th - Marnhull Community Café @10am
- 18th - The Annual General Meeting @19:30
- 21st - Qigong & Tai Chi @13:00 Methodist Hall
- 22nd - Bridge Club @14:00 Methodist Hall
- 24th - Marnhull Ramblers - Long Walk - 4-7 miles @10am
- 28th - Qigong & Tai Chi @13:00 Methodist Hall
- 28th - Bingo @19:00 British Legion
- 29th - Bridge Club @14:00 Methodist Hall
- DECEMBER**
- 1st - Craft Club @10am Methodist Hall
- 5th - Qigong & Tai Chi @13:00 Methodist Hall
- 6th - Bridge Club @14:00 Methodist Hall
- 8th - Marnhull Amblers - Short Walk - approx 3 miles @10am
- 12th - Qigong & Tai Chi @13:00 Methodist Hall
- 12th - Bingo @19:00 British Legion

13th - Bridge Club @14:00 Methodist Hall

16th - Marnhull Community Café @10am

20th - Bridge Club @14:00 Methodist Hall

29th - Marnhull Ramblers - Long Walk - 4-7miles @10am

**JANUARY 2023**

5th - Craft Club @10am Methodist Hall

**FEBRUARY**

2nd - Craft Club @10am Methodist Hall

3rd - The Marnhull Players - 'The Magical Tale of Snow White' Pantomime @19:00

4th - The Marnhull Players - 'The Magical Tale of Snow White' Pantomime @14:00

4th - The Marnhull Players - 'The Magical Tale of Snow White' Pantomime @19:00

5th - The Marnhull Players - 'The Magical Tale of Snow White' Pantomime @14:00

**FOR VILLAGE  
HALL BOOKINGS**Email: [bookings@](mailto:bookings@marnhullvillagehall.org.uk)[marnhullvillagehall.org.uk](mailto:bookings@marnhullvillagehall.org.uk)

Phone: 07376 911878 (between 9 and 5 weekdays)

**SUBMIT YOUR  
EVENTS INTO A  
LIVE CALENDAR**

On the messenger website and they'll be added to this diary in the next issue!

[www.marnhullmessenger.org.uk](http://www.marnhullmessenger.org.uk)

## STURMINSTER NEWTON MEDICAL CENTRE



### Klinik to replace eConsult

This new system, accessible from the Practice website allows you to submit requests for appointments, medical needs, sick notes, repeat prescriptions, prescription enquiries, nursing appointments, wellbeing support and administration enquiries.

The Klinik system and the clinical triage team together, will ensure you will get the support and services from the right person at the right time and if appropriate, will arrange appointments.

If you do not have access to a computer, the patient care co-ordinator team will support patients through the service by telephone, in the normal way, or via computer screens within the surgery.

Other surgeries across Dorset currently using this system, have seen vast improvements in their on the day/routine appointments and a reduction in time that patients experience in waiting on the telephone. If you have any questions, please don't hesitate to ask for more information at the Marnhull, Sturminster Newton or Abbey View, surgeries.

Please check the website <https://www.blackmorevallesurgery.co.uk> for a link to a demonstration.

### Flu & Covid Vaccinations

If you are eligible, you will be offered a flu vaccination and the Practice aims to offer a COVID Autumn booster in the same appointment.

Invitations are being sent to eligible patients in 'waves' to manage booking demand. Please wait to be invited. Telephone lines need to be available for patients requiring medical help so please do not call to chase your invitation. All eligible patients will be invited.

Patients with a mobile number on their records will be sent a text with a link to book an appointment online (your mobile phone will need access to the internet). If the Practice doesn't have your mobile number on file, now is the time to update it, by using the website to do this. If you don't have a mobile number registered, the Practice will telephone to book you in.

**BE AWARE:** The police have received reports of a scam involving patients being offered flu/covid vaccinations in exchange for a fee/bank details. The NHS will never: Ask you for your bank account/card details; Ask you for your PIN number or banking password; Arrive unannounced at your home to administer your flu/covid vaccine/

### Wellbeing

Our health and wellbeing is influenced by many factors, known as determinants of health. These are to do with things like our genetics, environment, work or financial situation, relationships and social factors and medical care. These are all interconnected, but only 20% of our health and wellbeing, is to do with medical care, in other words things that medical interventions can help with. The other 80% is affected by other factors.

So, Wellbeing is taking care of these other things and in particular, your mind as well as your body and this is really important. You may feel worried, or anxious about your life, your health or those close to you. You may feel bored, frustrated or lonely, so it's important to remember that it's OK to feel this way and that everyone reacts differently. Remember, for most of us, these feelings will pass, however the Wellbeing team at the surgery may also be able to help you if needed. You can contact the Wellbeing Team by phoning the Practice, or through Facebook @SturminsterNewtonandMarnhullCommunityKindness and @ShaftesburyCommunityKindness or by email [bvpsocialprescribing@dorsetgp.nhs.uk](mailto:bvpsocialprescribing@dorsetgp.nhs.uk). (Please note they are not clinical

staff, therefore cannot advise you on clinical matters)

### Prostate Cancer

It's the most common cancer in men, but most men with early prostate cancer don't have symptoms, as usually these don't appear until the prostate is large enough to affect the tube that carries urine from the bladder out of the penis (urethra).

Prostate cancer is not always life-threatening. But when it is, the earlier you catch it the more likely it is to be cured. When this happens, you may notice things like:

- an increased need to pee
- straining while you pee
- a feeling that your bladder has not fully emptied

These symptoms should not be ignored, but they do not mean you have prostate cancer.

## MARNHULL GREEN TEAMS



The weekend of 10-11 September saw the Great Marnhull Giveaway & Takeaway, organised by a Marnhull Green Team led by John Dowsett.

John writes: "What a delight and surprise this trial event turned out to be for everyone! Thirty households took part as Giveaways from their drives and gardens around Marnhull, and from their perspective it was a great success. An estimated half to three-quarters of their offerings became someone else's treasure, and the recipients were delighted! The sociability and generally festive atmosphere were added bonuses of the event.

"The commonest question was, when is the next one? We hope to announce a date for next year soon - and if you took part this year in one way or another and have any comments or suggestions we would really like to hear from you, so that we can make the next Giveaway & Takeaway even better! For now, many thanks to all who took part in all ways."

There are other events being planned by Marnhull Green Teams in the meantime.

On Tuesday 18 October we are delighted to say that Clive Whitbourn will be giving a talk on "Wilder Gardening - the joy of making space for nature" at Marnhull Methodist Hall, beginning at 7:30pm. Admission is free and refreshments will be available.

We will also be holding another Electric Vehicle Show, for anyone who is thinking of buying an electric car or bike and who would like to chat with villagers about their experiences with these forms of transport. This event will be run in conjunction with the Hub at the Village Hall during the morning of Saturday 5 November, 10-12. If you're thinking of 'going electric', do come along.

To keep in touch with what the Marnhull Green Teams are doing, you might like to join our newsletter distribution list. The newsletter is emailed roughly every month; is usually only one or two pages long; and is entirely free of any commitment! If you'd like to give it a try, or have comments on the Giveaway & Takeaway Days or any other 'green' topic, please email [marnhullgreen@outlook.com](mailto:marnhullgreen@outlook.com) or telephone (01258) 268714. You can also find us on the village Facebook pages.





• Open Daily • Family Friendly • Dog Friendly • Easy Access • Takeaway Service • Cater for Varying Dietary Needs • Large Car Park

**Timeless and steeped in character, charm & literary interest,  
The Crown Inn offers the very best in Dorset hospitality.**

Whether you're looking to dine or enjoy bar refreshments or to relax over a coffee or tea, our extensive meal & drinks ranges are sure to appeal.

We also specialise in functions & events catering for all types of celebratory occasions & family events, as well as corporate catering needs.

Our attractive outdoor spaces are ideal for al fresco dining & drinks, as well as to host BBQs, hog roasts & buffet events.

We also offer B&B accommodation by way of seven characterful, homely & well-equipped guest rooms.

For opening and food service times, menus and further information, please visit our website.



The Crown Inn, Crown Road, Marnhull, Dorset, DT10 1LN

Tel: 01258 820224

Email: [info@crowinn-marnhull.co.uk](mailto:info@crowinn-marnhull.co.uk) | Website: [www.crowinn-marnhull.co.uk](http://www.crowinn-marnhull.co.uk) | Facebook: [www.facebook.com/crowinnatmarnhull](http://www.facebook.com/crowinnatmarnhull)

**DSN Carpentry**

All internal and external carpentry undertaken

- Kitchens
- Bespoke Builds
- Renovations
- Garden Buildings

Tel: 07541377486  
Email: [dsncarpentry90@gmail.com](mailto:dsncarpentry90@gmail.com)

No Gimmicks Quality Products

**PITMAN WINDOWS**  
Windows - Doors - Conservatories

Combining a personal service with competitive prices using quality products

**Windows Doors Conservatories  
Replacement roofs Fascia Soffits & Guttering**

**Tel 01747 840268 or 0800 0833623**  
**Website: [pitmanwindows.com](http://pitmanwindows.com)**

## THE ANNUAL GENERAL MEETING



**The Annual General Meeting  
of the Marnhull Village Hall  
will be held on  
Friday 18th November 2022  
in the Village Hall**

**The doors will be open at 7.00 p.m.  
with the meeting starting promptly at 7.30 p.m.**

## NEW LOCAL BEREAVEMENT GROUP

A Marnhull resident, also a Health Champion for the Blackmore Vale Partnership like myself, suggested I get in touch to get this information to the village: A new local bereavement Peer Support Group has just started up as part of the Blackmore Vale Partnership social prescribing services. Run by volunteers, the aim is to provide support for those who are bereaved so they can take steps to rebuild their self confidence. Come along for cake and a cuppa and get together with others in the same position.

1st Friday in each month, 5-6.30pm Abbeyview Medical Centre, Shaftesbury.

Last Wednesday in each month, 10-11.30am Stour Connect, Sturminster Newton.

Any enquiries please email: [bvpsocialprescribing@dorsetgp.nhs.uk](mailto:bvpsocialprescribing@dorsetgp.nhs.uk)

## QIGONG & TAI CHI

Recommended for relaxation, reducing stress and even helping the body to heal when sick. Regular Qigong practice can reduce pain, stress and Anxiety and the effects of sickness from the body.

Mondays: Marnhull Methodist Hall 13:00-14:00

Wednesday: Big yellow bus project Shillingstone 11:00 - 12:30

Geoff & for other local classes

07941115352

[geoffrey1145@gmail.com](mailto:geoffrey1145@gmail.com)

[www.fountainofzentaichi.com](http://www.fountainofzentaichi.com)

## MARNHULL MUSIC SOCIETY

Meets every 3rd Monday of the month (except July and August) at 7:15pm in the village hall.

We listen to a varied programme of music (mainly but not exclusively classical) presented by one of our members and enjoy a social 'cuppa' during an interval.

For more information, please contact

Alan Loukes on 01258 821629

## MARNHULL AMBLERS & RAMBLERS

**Short walk (amble) approx 3 miles**

Second Thursday of the month a.m

Contact for details: Elaine Spencer-White - [elainesw48@gmail.com](mailto:elainesw48@gmail.com)

**Longer walk (ramble) 4-7 miles**

Last Thursday of the month a.m

Contact for details: Anne Dowsett - [dowsetanne52@gmail.com](mailto:dowsetanne52@gmail.com)

## THE MARNHULL AUTUMN CHARITY QUIZ 2022

formerly the 'Fish and Chip Quiz'

MARNHULL VILLAGE HALL

FRIDAY 14th OCTOBER

Teams of 6 £10 per head

Ploughman's supper with pud.

Bring your own drink, nibbles, scrap paper, pen and brains.

Tea and coffee on sale.

Bookings from individuals/less than 6 accepted

We try to accommodate all!

Contact

Andrew Webb: [alwebb@hotmail.co.uk](mailto:alwebb@hotmail.co.uk) 01258 821318

This year's proceeds to

**DORSET AIR AMBULANCE**

## ROYAL BRITISH LEGION



I am typing this as we struggle to come to terms with the loss of our Queen, Elizabeth II. She has always been a strong supporter of the Legion and indeed it was her who bestowed the title Royal on us in 1971. We of course do not know yet if the new King will be as strong of a supporter or indeed if we will continue

to be 'Royal'. However our main concern now is to follow any rules that come down regarding the mourning period. There is a book of condolence in the Legion should anyone wish to come down and sign it.

The jumble sale on September 17th had to be postponed as for one reason or another we could not get enough helpers. The new date is October 22nd make a date in your diary and come down for some bargains. Ironically after I cancelled I had three volunteers turn up entirely unsolicited.

It has been confirmed that the Parish Council has managed to arrange insurance cover for the Remembrance Day Parade this year. I will be contacting organisations for the Parade shortly but anyone is welcome to march. Just turn up at butts Close at 2:30pm on Sunday November 13th and Parade Marshall Owen Wells will put you right. If you do not wish to march the service at St Gregory's will be starting at 3pm, then after, all are welcome to come for refreshments at the Legion. If anyone would like to lay a wreath please let me know as soon as possible so we can order one. I have been asked by one of the skittle team to find a sticker up. If you know anyone who wants to earn some pocket money give me a call and I will pass your information on.

### October Entertainment

**Sat 1st - Tony Letts**

**Mon 3rd - Bingo 7pm**

**Sat 8th - The Originals**

**Sat 15th - Bill Shannon's Soul and Motown Disco**

**Mon 17th - Bingo 7pm**

**Sat 22nd - Rip It Up**

**Sat 29th - Stage One**

**Mon 31st - Bingo 7pm**

\*\*\*\*\*

For Branch business contact Jack Whitehead on 01258 820800

or [whiteheadjack51@gmail.com](mailto:whiteheadjack51@gmail.com)

For Club business ring Tony on 01258 820397



3 Newbury, Gillingham  
SP8 4QX (Opposite Lidl)

Te. 01747 821010

[www.norddisorset.org.uk](http://www.norddisorset.org.uk)

Reg. Charity No. 1110328

**We can provide the following:**

- New & used equipment
- Hire equipment
- Disposable items
- NHS hearing aid batteries
- Information & advice
- Volunteer opportunities
- Call us for information
- Open 10am to 4pm Tues, Thur & Fri
- 10am to 1pm Sat.



6 New Street, Marnhull DT10 1PY

**Tiling, Slating, Leadwork, Timberwork**  
**New & re-roofing work undertaken**

Nick Upshall  
Tel: 01258 821231  
Mobile: 07801 851079  
[www.camelotbuilders.co.uk](http://www.camelotbuilders.co.uk)

**Paul Woodrow**  
Home and Garden Services



Fully insured garden maintenance and handyman service across the Blackmore Vale

**07392727584**

[office@woodrowhomeandgarden.co.uk](mailto:office@woodrowhomeandgarden.co.uk)

[@woodrowhomeandgarden](https://www.facebook.com/woodrowhomeandgarden)

[www.woodrowhomeandgarden.co.uk](http://www.woodrowhomeandgarden.co.uk)

**The Barn  
Bed & Breakfast**

Quiet, Comfortable and Friendly  
on the edge of the village

Hillside  
Marnhull  
01258 820912

[www.thebarnbedandbreakfast.co.uk](http://www.thebarnbedandbreakfast.co.uk)

**PARTNERSHIP  
FIRE AND SECURITY**

Contact

Tel: 01747 858888

[enquiries@partnershipsecurity.co.uk](mailto:enquiries@partnershipsecurity.co.uk)

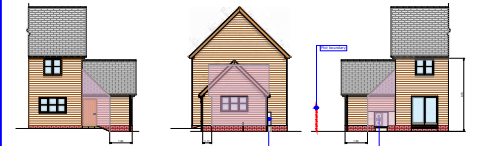

**IAN OSMAN  
DRAUGHTING SERVICES**

AutoCAD building and landscaping  
design service.

For more information please contact me on

01258 821690 / 07746 539943

[ido3d2d@gmail.com](mailto:ido3d2d@gmail.com)

& Facebook

**The Old Bank  
Bed & Breakfast**

*Comfortable, friendly,  
Family Home  
In the centre of the village*

The Old Bank,  
Burton Street, Marnhull  
01258 821019

[enquiry@theoldbank-marnhull.co.uk](mailto:enquiry@theoldbank-marnhull.co.uk)



Lavenders  
Green

Complementary Therapies  
Yoga, Reiki, Reflexology, Massage, Aromatherapy  
Human Givens Psychotherapy/Counselling &  
Radionic Treatment

**Tanya Green ITEC  
Traditional Yoga Association**

T: 01258 820410  
M: 07729 301387  
E: [tanya@lavenders-green.com](mailto:tanya@lavenders-green.com)

Online Yoga classes available at  
[www.lavenders-green.com](http://www.lavenders-green.com)

Contact details for Your Dorset Councillor  
**Graham Carr-Jones**

☎ 01963 364005

✉ [Clrgraham.carr-jones@dorsetcouncil.gov.uk](mailto:Clrgraham.carr-jones@dorsetcouncil.gov.uk)

Graham Carr-Jones  
Stalbridge & Marnhull

Cabinet Member for  
Housing, Community Safety  
& Emergency Planning





# ENGINE EVOLUTION.com



**DIAGNOSTICS - REMAPPING - SERVICING - REPAIRS  
AIR CON - WHEEL ALIGNMENT - ROAD - RACE - RALLY**

**07504 511730 01935 362811**



**UNIT 11 / 12  
GIBBS MARSH TRADING ESTATE  
STALBRIDGE, STURMINSTER NEWTON, DT10 2RY  
CONTACT NIGEL MARSH**

**WWW.ENGINEEVOLUTION.COM**

## Marnhull Computers

Specialists in the setup and repair of all makes of computers, laptops, tablets and mobile phones



- New computers
- Upgrades & Repairs
- Speed up slow computers
- Software rebuilds
- Virus/Malware removal
- Screen Replacement

**Do you have an old or broken computer and would like to safely recover treasured documents or pictures?**

Based in the village with over 35 years experience and supplier to The Crown Inn

**Call Mark on 01258 821686 or email mark@marnhullcomputers.com**

## EXPECT *Far* MORE

At Farnfields Solicitors you can always expect a warm welcome combined with dedicated expertise and transparent straightforward pricing. All in all, when choosing us you can expect far more peace of mind.



e-mail: [info@farnfields.com](mailto:info@farnfields.com) or visit [www.farnfields.com](http://www.farnfields.com)



*Farnfields*  
SOLICITORS

### ACCOUNTANCY PLUS (DORSET) LIMITED

CHARTERED ACCOUNTANTS AND TAX CONSULTANTS

- Quick Books & Sage Expertise
- Accounts Management
- Personal & Corporate Taxation
- Book-Keeping

**01258 820709**

Email: [info@accountancyplusdorset.co.uk](mailto:info@accountancyplusdorset.co.uk)  
Contact: Mr Kim Harden, FCA, FCCA  
4 New Street, Marnhull DT10 1PY

## Happy Pets and Home Service

House Sitting

Pet Care

Garden Care

Painting and Decorating

Call Juliet: 07773 566425



**Hawtree & Sons**

RIVERSIDE GARAGE, A30 WEST STOUR, GILLINGHAM,  
DORSET SP8 5RJ

MONDAY TO SATURDAY: 7am - 10pm • SUNDAY: 8am - 10pm

MARNHULL STORES, NEW STREET, MARNHULL, DORSET DT10 1PX

MONDAY TO SATURDAY: 7am - 8pm • SUNDAY: 8am - 1pm

Serving the Blackmore Vale for over 30 years *Local...Convenient...There for you!*

**MARNHULL**

**STORES**

**ALL DAY SUNDAY**

**NOW  
OPEN**

**8am - 8pm**



**ROYAL BRITISH LEGION  
MARNHULL BRANCH AND CLUB**

LEGION HALL, SODOM LANE, MARNHULL  
TELEPHONE: 01258 820613

Clubhouse open hours

Mon-Thur 8-11.30pm, Fri 8-12pm, Sat-12-3pm, 8-12pm

SKITTLES (LEAGUE and FRIENDLY) - DARTS - POOL  
LIVE ENTERTAINMENT

(see Blackmore Vale Magazine or ring for details)

BRANCH AND CLUB MEMBERSHIP NOW AVAILABLE

**FAMILIES MOST WELCOME**

Come along and see what we can offer you

Branch: [branch@marnhullrbl.wanadoo.co.uk](mailto:branch@marnhullrbl.wanadoo.co.uk)

Club: [club@marnhullrbl.wanadoo.co.uk](mailto:club@marnhullrbl.wanadoo.co.uk)

Alternate Mondays  
**PRIZE BINGO**  
7.10pm  
Open to everyone

**OXFORD**  
Building & Carpentry Ltd

- Complete House Renovations • Staircases Remodelled
- Kitchen And Bathroom Installations • 1st And 2nd Fix
- Cut And Truss Roofing • Replacement Doors

Contact Pete Oxford T: 01258 820850  
M: 07970 156735 [oxfordp@yahoo.co.uk](mailto:oxfordp@yahoo.co.uk)  
Chippets, Chippel Lane, Marnhull DT10 1NN



*Williams Florist*  
floristry & gardening

Do you have something  
special to say?

Full florist service available  
Local delivers & Eflorist relay  
members

*Say it with flowers...*

Station Road, Stalbridge  
Dorset, DT10 2RQ

Tel: 01963 362355

Email: [williamsflorists@live.co.uk](mailto:williamsflorists@live.co.uk)

[www.williams-florist.co.uk](http://www.williams-florist.co.uk)



**PESTWRIGHT**  
**THE COUNTY MOLE**  
**CATCHER**

Complete pest control services  
Friendly, reliable service  
BPCA qualified,  
Insured  
Call Jim on  
01963 362292



- All aspects of tree surgery
- Dismantling and felling
- Pruning
- Tree disorders and solutions
- Tree pest and disease analysis

Telephone 01747 850 253  
e-mail [info@hawesarborists.co.uk](mailto:info@hawesarborists.co.uk)

We are very proud to have received Arb Approved contractor status and are covered by the Government accredited Trust Mark scheme.  
NPTC Certified • Tech.Arbor.A Qualified  
All work carried out to BS3998 Standards



Peter Jackson  
Funeral Services  
at  
Henstridge

Independent Family owned and run  
Funeral Directors  
24 hour service  
Private Chapel of Rest  
Telephone: (01963) 362570



Foot Care in the Comfort of Your Home.

Corns, calluses, problem nails etc.  
Friendly, female practitioners

[www.bmvfootcare.co.uk](http://www.bmvfootcare.co.uk)

01258 820203 | [gillian@bmvfootcare.co.uk](mailto:gillian@bmvfootcare.co.uk)

**CT Building**

Building & Carpentry  
Mappowder, Dorset  
07815 859 339  
[c-tbuilding.co.uk](http://c-tbuilding.co.uk)  
[ctbuilding606@gmail.com](mailto:ctbuilding606@gmail.com)

**GRASSBY & CLOSE  
FUNERAL SERVICE**

4 Innes Court,  
Sturminster Newton,  
Dorset DT10 1BB

01258 471024

[www.grassbyclose-funeral.co.uk](http://www.grassbyclose-funeral.co.uk)



*Seamstress*

Clothing alterations,  
made to measure curtains  
and blinds.

All jobs considered.  
Call Rosie 07780703641  
[rneedlethread@hotmail.com](mailto:rneedlethread@hotmail.com)

**James Colmer Hair & Beauty LTD**

The Beauty Room by Jane Colmer

Simply struggle to cut your toe nails?

Come see Jane and get those toe nails seen too,  
A simple service with a caring touch!

Men and ladies' feet are very welcome!

30 mins service.....Just £14

Burton Street, Marnhull  
01258 820033

Many more treatments available



CLASSES IN BROADSTONE, WINCANTON, MARNHULL,  
MOTCOMBE, OKEFORD FITZPAINE

**CONTACT: HAYLEY SANDELL,  
POUND PRO**

07786 553889

[HAYLEY.SANDELL@OUTLOOK.COM](mailto:HAYLEY.SANDELL@OUTLOOK.COM)

## A SUMMER OF SUNFLOWERS CHARITY ART EXHIBITION & SALE



MARNHULL VILLAGE HALL - SUNDAY 23 OCTOBER  
1pm to 4pm - Entry £2 - Children free - All proceeds  
to charity

### **ORIGINAL ART & HANDPAINTED CARDS FOR SALE - DELICIOUS CAKES - RAFFLE**

Deborah Chisman's Art for Everyone classes and the Blackmore vale art group joined forces this year to draw and paint sunflowers over the summer. Please come and see the wonderful art on display, maybe even purchase an original painting at very reasonable cost, enjoy some delicious tea and cake, buy a card or two and enter the raffle to win a fabulous prize! All funds raised go towards helping families displaced by the ongoing war in Ukraine.

### **ART FOR EVERYONE**

Art classes at Marnhull and Durweston village halls are back up and running and feeling pretty much (dare i say it!) back to normal. I have my fingers crossed as I type! What have we been up to? Well we have experienced lots of different subjects and experimented with a wide variety of media over the past year and a good amount of work has been created all ready for a fabulous exhibition before too long so watch this space! Autumn last year saw us drawing dried poppy seed heads in water soluble graphite pencil and then painting them with tea, strong English breakfast, delicate Earl Grey, turmeric chai or fruit infusions all of which produced beautiful subtle shades. Blue bell woods in the spring were captured in brilliant bright shades of brusho, powdered pigment which explodes with colour when water is added. We painted the Barn owls at Bere Marsh farm in gouache from amazing photos kindly supplied by local wildlife photographer Alan Wicks. Vintage tractors in watercolour were fun as were quirky giraffe portraits. Our Sunflower collage project in the summer term was very poignant. Using layers of coloured paper and watercolour paint in the colours of the Ukrainian flag we combined newspaper cuttings of the war in Ukraine with bright sunflowers, the national flower and a symbol of hope. Each painting is unique and a record of the difficult and ongoing struggle. This got us thinking and talking. As a

couple of class members host Ukrainian families, could we use our paintings to raise some much needed funds? I do hope you will come along and support our efforts on Sunday 23rd October at the Summer of Sunflowers art exhibition & sale.

See you there, there will be cake!

Deborah Chisman - deb\_chisman@hotmail.com  
01258 820349 / 07746 996889

### **Would you like to join an Art for Everyone**

**class?** All levels welcome including beginners, improvers and those with experience looking for inspiration and direction. You are welcome to come along and try a class for free, just drop me a line to arrange a visit. I have a few spaces at Durweston Monday afternoon class 1 to 3:30pm

Duurweston Monday morning class and both Marnhull classes on Tuesdays are fully enrolled.

## CITIZEN'S ADVICE

We need your help. Many people in North Dorset are facing extreme hardship as a recession looms. Rising food costs, redundancy, repossession, fuel and energy price rises, and more, all create huge pressure and anxiety for families. Citizen's Advice is doing its best to help. But we need more advisers. Will you step forward to volunteer a day a week? You will be trained in how to support those in need. This is hugely urgent. Call us on 01747 834900 for more information. Thank you.

## MARNHULL WOMEN'S INSTITUTE

I had heard of Julia's House but it wasn't until I heard Amanda Valentine's excellent presentation that I had any idea of the enormous scope and commitment of this extraordinary organisation. I suspect many others in the audience were similarly astonished.

Julia's House is a hospice for children in Wiltshire and Dorset with life threatening or life-limiting conditions. Recognising the catastrophic burden such a situation places on a family, the focus of the staff is to care for every member of the afflicted household and support them in every way possible. Each sick child is allocated 200 hours per year and this time can be used however is most suitable for that child and those who care for him. A morning a week in the noisy, fun-filled play area with its array of magical toys and experiences could give exhausted parents a valuable bit of free time. A nurse and a helper could take the child for a walk in the park or to a beach. One little girl wanted to ride a pony, so that is what she was helped to do. One boy just loved to splash in a bubble-filled jacuzzi. There are things on offer that almost defy the imagination: a trampoline just for wheelchairs, a swing for bedbound little bodies, a room where the patterns on the floor change on demand or music can be conjured with a wave of the hand. Other children in a family with a very sick child often find themselves sidelined as the needs of their sibling trumps their own. Julia's House staff arrange outings and holidays for these youngsters, taking them camping or on other adventures where they make friends with other children who understand what they are enduring.

Once a child and his family have come under the care of Julia's House they remain so until the child is eighteen when he is progressed on to other organisations. If, as sadly often happens, the child dies, enveloping support is given to all the family and the final days can be spent in a dedicated suite with the love and full time attention of familiar nurses and helpers. Afterwards the bereaved family remains part of the bigger family of Julia's House and bereavement counselling is offered.

Julia's House is 90% funded by public donations. Fundraising is constant and relentless and much of the money to run this fantastic organisation comes from legacies in wills.

In October our talk is entitled "Hedgehogs in need."

## MARNHULL PLAYERS PANTO

We started rehearsals on Thursday 1st September and we are off to a great start. The cast have had some great ideas of what to do with their characters and the portrayals of them are brilliant to start with. Once we have learnt our words we will have more freedom to expand. We are doing rehearsals a scene at a time so we can try and work out each scene before we put it all together. This is providing to be a good idea as it limits the amount of rehearsals people are needed at. I just hope we can all remember scene one when we come back to it haha!

As for the stage developments you will probably start seeing some changes over the next few weeks and we can then get painting the scenery. that is when the show really starts to take shape as you can start to see what the audience will see. It is very exciting getting back on the stage again. You don't realise how much you miss it until you get back on it. We are very excited for February.

Would you like to be involved in this fun pantomime group? Even if you don't want to be on stage, there's plenty of roles to help out with - no experience needed, we would love to have you on board. Contact Emma at marnhullplayers@gmail.com.

Thanks,  
The committee and cast



## NEWS FROM TRADING STANDARDS: BUTTON BATTERY SAFETY

Button batteries are used to power everyday items including car key fobs, remotes, and children's toys, but if swallowed, they could badly injure or kill a child.

Button batteries react with saliva to create caustic soda, which is the chemical often used to unblock drains. If a child swallows a button battery and it gets stuck in their food pipe (oesophagus), it can burn a hole and cause internal bleeding, or even death. If a button battery gets into the stomach, it can also cause significant tissue damage.

Larger lithium 'coin cell' batteries (about the size of a five pence piece) are the most dangerous. Smaller batteries can be inserted into places such as ears and noses, causing serious injuries for children if undetected.

- **Store spare batteries securely** and out of children's reach. Be careful when opening multi-packs of button batteries to ensure they do not fall on the floor.
- **Know what products use button batteries** and check that the button battery compartment is secure. Put products with unsecured button batteries out of children's reach. Under product safety regulations, button battery compartments in toys require to be secured.
- **Educate older children about button batteries** including why they should not play with them or give them to younger children.
- **Discard dead button batteries straightaway** as even dead button batteries can still have enough power to badly hurt a small child. When you remove a button battery, store it securely, and recycle it properly and promptly.
- **Act promptly if you suspect a child has swallowed a button battery**, take them straight to the nearest A&E department or call 999 for an ambulance. Take the battery packaging, toy, or gadget if you can, to help staff identify the battery. Symptoms may not be obvious. Your child might be coughing, gagging, or drooling, or pointing to their throat or tummy. Unclear or fluctuating symptoms mean it is important to be vigilant. Do not let your child eat or drink and do not make them be sick.

## MARNHULL WAR GRAVE

A few months ago Revd Gaenor Hockey was informed by the Commonwealth War Graves Commission (CWGC) that there is a war grave in St Gregory's Churchyard; could they put a small notice at the entrance to the churchyard informing visitors of this fact.

Searching the CWGC records I found that, indeed, Aircraftman William John Lloyd is buried here. We have a record of all the graves in St Gregory's churchyard. Searching this revealed that at grave P33 (Northern graveyard extension) there is a Service Headstone, "909807 Aircraftman W.J.Lloyd, Royal Air Force, [died] 3rd September 1940, age 24".

His name also appears on the War Memorial at the Eastern end of New Street. If you are interested in seeing this grave, enter the churchyard at the Church Hill entrance. Follow the mown path (approximately parallel to New St).

About three quarters way along this path, look to your right and, between your path and the North boundary, you will see the upright service gravestone, with the RAF crest at the top. In the immediate vicinity you can see other Lloyd family graves. Of particular interest to some, there is the grave of William's father, who lived at "Woodlands Farm, Ham Lane" - presumably where Woodlands Close now stands.

Nick Lalor (Churchwarden)

## MARNHULL LUNCH CLUB - HAPPY 90TH BIRTHDAY NORVAL!!



The committee, volunteers and guests at the Marnhull Lunch Club were delighted to celebrate the occasion of Norval Faro's 90th Birthday when we met at our monthly get together in the Village Hall on 2nd September. Although it was Norval's Birthday later in the month, we thought it appropriate to show her our appreciation, as well as affection, for everything she does for the village Lunch Club in her position as Chairperson.

Christine Frith and Norval founded the Club in 2002, which originally had 39 members, and this membership has now almost doubled. When we sadly lost Christine, Norval stepped up and took over the responsibility of Chairperson.

The food for the club was always cooked at the Exchange Kitchen in Sturminster Newton but when this was no longer available to us, Team Crown took over this responsibility in 2017 and now produces outstanding meals every month. Christmas dinner is always a traditional turkey dinner and Christmas pudding with Carols sung, often with the children from St. Gregory's and St. Mary's Schools.

Norval's previous professional life as a District Nurse is evident in her role at the MLC. She genuinely cares about all our members and keeps in touch with them during the month, especially those who live alone or who might not be very well.

As already said, given all the hard work and commitment Norval has shown to the MLC over the last 20 years we felt it only appropriate that we gave her the birthday celebration she deserved. We all had fun and we know Norval did too!

We always welcome new faces at the club so if anyone would like to come and join us on the first Friday of each month, please call Norval 01258 820058 for more information.



## TOTAL POP PARTY - THE SCREAM & SHOUT TOUR!

Who are we? TPP! 'Total Pop Party' is back! It's fair to say, the children of today have had enough! From home schooling to lockdowns, they deserve to have some fun! Come join the TPP girls and celebrate the modern-day pop legends! Including Little Mix, Ariana Grande, Taylor Swift, Katy Perry, Pink, Ed Sheeran, Olivia Rodrigo and many more! Featuring all your favourite hits, this concert is full of your favourite dance moves, plenty of audience interaction and screaming from the top of your lungs! Brilliantly entertaining and a non-stop pop party from start to finish! 'Total Pop Party' is an excellent introduction for kids who are too young to go to the big concerts but don't want to miss out on seeing their favourite pop stars! There's even a chance to meet the TPP girls after the show they can strike their favourite pose and be part of the gang!

We can't wait to see you at the BEST party in town!

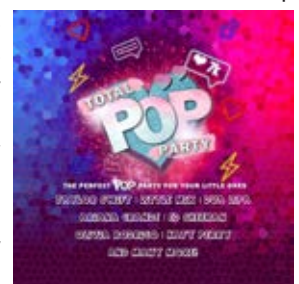

## OUR LADY'S CHURCH



**Catholic Church of Our Lady,  
Marnhull & St. Benedict's,  
Gillingham**  
(www.  
marnhullandgillinghamrc.  
org.uk) Tel. 01258 820388

Parish Priest: Fr. Francis Straw OSB

Sunday Masses - 9:30am and 6pm (Marnhull) / 11am (Gillingham)

Weekday masses: check the website.

**Parish News:** Refreshments are available after 9:30am Sunday mass most weeks.

**HMP Guys Marsh:** Chaplain: Deacon Michael Turnbull

Contact: michael.turnbull@prcdtr.org.uk



On Friday (9th September) at Our Lady's Catholic Church in Old Mill Lane, for our monthly Churches Together shared prayer. Plans had to be changed because of the sad demise of Her Late Majesty, Queen Elizabeth II, but it seemed providential that we should have this opportunity to come together and pray for the repose of her soul, for our loving Father's support for her grieving family and for our new King, that God's wisdom will be with him and God's strength will support him as

he serves the people of the Kingdom and Realms entrusted to him. Our Lady's has just one small bell, but we rang it with enthusiasm as we joined all the churches of our nation in tolling out our sorrow and our prayers for our departed Queen. May she rest in peace and rise in glory.

**Condolences from Pope Francis** - "Deeply saddened to learn of the death of Her Majesty Queen Elizabeth II, offer my heartfelt condolences to Your Majesty, the Members of the Royal Family, the People of the United Kingdom and the Commonwealth. I willingly join all who mourn her loss in praying for the late Queen's eternal rest, and in paying tribute to her life of unstinting service to the good of the Nation and the Commonwealth, her example of devotion to duty, her steadfast witness of faith in Jesus Christ and her firm hope in his promises. Commending her noble soul to the merciful goodness of our Heavenly Father, I assure Your Majesty of my prayers that Almighty God will sustain you with his unfailing grace as you now take up your high responsibilities as King. Upon you and all who cherish the memory of your late mother, I invoke an abundance of divine blessings as a pledge of comfort and strength in the Lord." Franciscus Given at the Vatican, 8th September, 2022.

### A lifeline for married couples:

Are you:

- Anxious about your marriage relationship?
- Alone or distant from your partner?
- Disillusioned or bored in your marriage?
- Without the time or desire to communicate?
- Experiencing coldness or conflict?
- Frustrated, hurt or angry with your partner?
- Unable to see how to change your situation?

Retrouvaille is a programme to support couples who have difficulties in their marriage. It brings a positive focus, new hope and helps nourish and grow your marriage. Many couples headed for divorce have successfully saved their marriages by attending and using the tools provided. The programme helps spouses uncover or re-awaken the love, trust and commitment that originally brought together. It helps them through

difficult times whether they are disillusioned or in deep misery. There is no group therapy or group work.

For confidential information about 'Retrouvaille' or to register for the next programme commencing with a Virtual weekend on 13-16 October 2022. Call or text 07887 296983 or 07973 380443 or email [Retrouvailleukinfo@gmail.com](mailto:Retrouvailleukinfo@gmail.com) - or visit [www.retrouvaille.org.uk](http://www.retrouvaille.org.uk)

## CHURCHES TOGETHER

### Ecumenical talk at St Andrews Church, Todber

Mrs Jacintha Bowe gave an ecumenical talk at St Andrew's Church Todber on Christian ethics and the environment. Entitled How To Love a Worm, the talk aimed to clear away some of the misconceptions that people might be holding about whether Christianity can contribute to the eco-debate; it also aimed to show how Christianity can deepen secular approaches to the environment. The final part of the talk examined the eco-spiritual approaches of Saints Francis and Benedict, and their communities, to make the point that they are highly appropriate for 21st-century ecological practices.

### Village Prayer Service was held at Our Lady's on Friday 9th of September. Churches Together in Marnhull



met on Friday (9th September) at Our Lady's Catholic Church in Old Mill Lane, for our monthly shared prayer had to be changed because of the sad demise of Her Late Majesty, Queen Elizabeth II, but it seemed providential that we should have this opportunity to come together and pray for the repose of her soul, for our loving Father's support for her grieving family and for our new King, that God's wisdom

will be with him and God's strength will support him as he serves the people of the Kingdom and Realms entrusted to him.

Our Lady's has just one small bell, but we rang it with enthusiasm as we joined all the churches of our nation in tolling out our sorrow and our prayers for our departed Queen. May she rest in peace and rise in glory.

With the welcome support of Paul Bowe, one of our organists, we then sang heartily the hymn, *Jerusalem the Golden*, thinking both of the hoped-for heavenly destiny of our late beloved Sovereign and ours too, of which our coming together in the House of God is a prefiguration.

Fr. Francis offered a few thoughts on the method of prayer known as *Lectio Divina*, which involves careful reading of a passage scripture, rumination by each person on its meaning for them, moving into silent prayer that its purpose will be fulfilled in us and culminating in a moment of resting in God, beyond thoughts, beyond words, beyond images.

We then used this method to pray the Magnificat, that wonderful poem of praise of God which Mary the Mother of Jesus sang as she visited her cousin, Elizabeth, which is preserved in St. Luke's Gospel.

We ended our time of prayer together by singing the hymn which is based on the Magnificat itself, "Tell Out, My Soul, the Greatness of the Lord"

## THE METHODIST CHURCH

'All is safely gathered in ere the winter storms begin...'

A line from a harvest hymn which has stuck in my mind since my childhood on a farm in Yorkshire. Cosy, safe and ready for winter, very evocative but let's hope and pray that we can be cosy and safe during the approaching months. I'm sure that I am far from alone though in having a real concern about what will be the cost of keeping warm and cooking this winter. What can be done, particularly for folk who financial resources are limited and those whose health is not good? The Government will help I'm pretty sure, but still many find these times difficult and worrying. Do you have thoughts on what the village community could do to assist?

## The Vine Youth Ministry - [www.vym.org](http://www.vym.org)

On a happier subject, the Vine Youth Ministry (VYM) is based in Yeovil. It was set up in 2006 by Daniel and Amanda England. Its mission statement 'Working with young people to help them realise that God loves each one of them' neatly sums up their aim. To this end, Daniel, the minister, visits school assemblies presenting exciting bible stories and songs. During lockdown Daniel produced online videos which were accessed across the UK and abroad! Since lockdown he continues to do school face to face visits mixed with online videos - Virtual MiniMix assemblies. This has proved to be a hit with the children who can send him messages and request a visit to their school from him. Daniel, who used to teach music, is doing a great job and his work is increasing. There is no charge, the online videos and visits are absolutely free. His sons tell Daniel he needs to start using TikTok - 'whatever that is', as he says! To me it seems me that the work Daniel is doing is really important and in many ways is the future for ministry, especially to the young who are so very savvy about and into online learning and influence. You know what is coming next - Vine Youth Ministry needs financial support to continue and expand its work. If you would like to support this really valuable ministry you can download a sponsorship form from their website [www.vym.org](http://www.vym.org). **Please do have a look**, even a small regular or one off donation will really help to get the gospel message across to young people in a fun and easy to understand way, not only locally but more widely across the UK and beyond. Thank you. On another positive note, with the Churches Together team we are busily gathering up for the Village Harvest Supper on 29th September and I hope to be able to report in the next edition that a good time was had by all. Working together with St Gregory's and Our Lady's Churches is a pleasure and services where all the churches get together to worship are very rewarding. **These are the ones planned for the next few months and you and your friends and family are invited to join us at any of all of them:**

- **Platinum Jubilee Service: 3pm at St Gregory's Church on Sunday 9th October**
- **Remembrance Service: 3pm at St Gregory's Church on Sunday 13th November**
- **Joint Advent Service: 3pm at St Gregory's Church on Sunday 27th November**
- **Candle Lit Carol Service; 5pm at Marnhull Methodist Church Wednesday 21st December**

### LUNCH TIME ORGAN RECITAL

BY

**STEPHEN BINNINGTON**

**12 NOON ON THE 21ST OCTOBER**

AT

**THE METHODIST CHURCH**

**Donations for the DEC Appeal  
for the Flood Disaster in  
Pakistan**

**COFFEE SERVED FROM 11 AM**



Hope to see you at all or some of them! Gillian

**'The grass withers and the flowers fall, but the word of our God endures forever'**

Isaiah Ch 40 v.8

## ST GREGORY'S CHURCH



'God and the art of motorcycle maintenance.'

Do you know that feeling? You know; the one where you are flowing along, content, empty mind, calm, relaxed body, smooth brow? Free from thoughts, no expectations, no time - just gradual renewal.

It happens by accident sometimes. Maybe you don't feel you deserve that. If you're not sure what

this feeling is, watch extreme sports on Youtube. On the surface you will see adrenalin and the baffling bravery of youth; but you will also see a calmness and self-connection. They silently express themselves.

This state is sometimes called 'flow-state'. For me, to reside in this state for any time is precious prayer and connection to our creator God. Often there are no words needed in prayer. In the moment I feel there is a shared delight with our creator in the experience of flow which is timeless and beyond words. I think he needs this as much as we do. After all, we are told that God looks on us as a mother nursing her child. So, it seems reasonable to assume God must adore watching us at peace in our environment and with ourselves. After all, how can we love our neighbours as ourselves, if we don't take time to love ourselves?

Robert Pirsig's 1974 best selling book: Zen and the Art of Motorcycle Maintenance had a problem trying to set out what Zen is because, as the philosopher explained, Zen is nothingness and as soon as you try to capture and summarise it, it makes no sense. Pirsig's quest for meaning is played out over a motorcycle road trip, which is where I find the tranquility of flow. Before my ordination and starting my role as your curate to St Gregory's church, my wife and I took a motorcycle trip of our own. We spent many hours lost in delight rural France. We had an old road atlas and no sat nav and so consequently were unable to plan a route so just rode along fabulous roads searching for lunch. On the Sunday we came across a motorcycle blessing at a French monastery. About 150 bikers turned up on all sorts of bikes in leathers, tattoos, and grins. We all filled respectfully into a mass and afterwards rode the private drive to queue for our individual blessings. It was perfect. Over the coming years of my curacy to train with Revd Gaenor, I hope to meet you and to see where you meet God or to sit and chat about our God who came so that we would have life and have it in all its abundance.



## ST GREGORY'S CHURCH

**Sat 1st - Sun 2nd October Harvest Festival Weekend - Everyone welcome!** Gift Day Saturday 9am - 5pm: church is open with harvest displays and two informal and free organ recitals at 10am and 2pm given by Stephen Binnington. Harvest Services Sunday at 8am and 10am. Envelopes for the Gift Day will be distributed through the Marnhull Messenger. If you are able to support the church - however small the gift - we would be very grateful. **Mon - Fri 3rd -7th October. Creative Harvest** As part of our Harvest Celebrations - an opportunity for local people to share their creative passions in our beautiful village church.

**Contact Us.** - Revd Gaenor Hockey, Parish Priest - (Part time) 01258 821605 [gaenor@protonmail.com](mailto:gaenor@protonmail.com)

Revd Angus Mayhew, Curate - (Part time in Marnhull) [revangusmayhew@gmail.com](mailto:revangusmayhew@gmail.com)

**Churchwardens** - Nick Lalor - 01258 820553 (Church & Churchyard)

Sharon Martin - 01258 821009 (Church and Looking to the Future project)

**Visit Us:** Church open daily 9-4.30pm

**Online:** [www.stgregorysmarnhull.org.uk](http://www.stgregorysmarnhull.org.uk)

Facebook @stgregschurch



## ST GREGORY'S C OF E PRIMARY SCHOOL



**CONCENES.** St Gregory's shares in mourning the loss of our dear Queen Elizabeth. A special book of condolence has been in place at the school where children can write their own message. In addition, all classes have visited Church to say prayers for the Queen and her family. Each day we also have a period of reflection lasting throughout the period of mourning. For many of our children this national event is their first experience of losing someone so familiar to them. A school's responsibility is not just in the education of our pupils but also their wellbeing; bereavement is very hard, especially for a child and can be rather bewildering, by sharing in the grief and talking about it we as a school can best help each other through difficult times.

RIP Your Majesty.

**GOVERNORS.** Every school relies heavily on good governance, they are responsible for overseeing the management side of the school, its strategy, policy, budgeting, premises and staffing. This is achieved by working closely with the senior leadership team and supporting all teachers in their subjects. The skills required to be a governor are broad, there is certainly no need to be an educationalist to join. Marnhull and the broader local area are rich in both skills and experience across multiple professions and so in turn is the board of governors.

The whole board meets about once per half term with sub committees on quality of learning and finance meeting in addition to this. Each subject taught at St Greg's will also have a Governor allocated as a link, they will work alongside the lead teacher of that subject. These close working relationships are what make a school successful. Governors are expected to both challenge and support the staff, it is by this method that the best learning outcomes are achieved for the children, something every Governor is passionate about.

**DOG BLOG.** Daisy our school dog has been back in school, as her role develops the children will see far more of her. Daisy has been a revelation at the school, plenty more from her throughout the school year.

**COOKIE & CREAM.** Our school guinea pigs have also been enjoying the start of term. Their grooming regime picks up pace once the children are back at school, they of course both wish to look tip top each and every day. Here our recently appointed Guinea pig monitors Jacob and Phoenix are assisted by Ripley (left) in giving Cookie & Cream their first bath of the new term. Blue rinses are booked in for next month.

**HEDGEHOGS.** With the help of our "veteran" Yr. 1 children our new starters have settled in to school life very well indeed. A great way of getting to introduce themselves is the string game; each person holds the ball of string and tells all something about themselves before passing the ball to someone else whilst holding onto a bit of string, before long we have the spiders web you see in the photo.



Beyond getting to know one another Hedgehogs have been exploring their surroundings both indoors and outdoors. Of particular fun are our trikes and bikes. Throughout the school year all classes endeavour to spend as much

time outside as possible. Our running track is used daily as we run/walk a daily mile, it's a time for the kids to chat and take the edge off prior to settling in class.



**MARTHA'S MONTHLY MESSAGE.** This month we have welcomed the newest member of St Gregory's, Mrs Brown who is currently Foxes teacher (Yr.6). She is really nice and loves teaching and Foxes love her teaching them too. She has started a worry box for anybody in Foxes to help make their worries go away. Foxes' new topic is Mexico and the Mayan era which will be really interesting. We have started a new class reading book called Holes by Lewis Sacher. It is really good to be back, and I cannot wait to report back in next month's issue.



**FOXES.** Our Yr. 6's have a full year ahead of them, SATS will feature as will some fun end of year activities. First up the class dished up democracy by voting in young governors, pupil parliament and sports ambassadors. The candidates presented to staff and the rest of the school with very persuasive speeches displaying an excellent understanding of the importance of these roles. Meet our young governors from left to right:

Mia, Eve, Laura and Katy.

Our pupil parliament is made up of

Laura - Chair

Martha - Vice Chair

Katy - Scribe.

This year our sports ambassadors are:

Red Pandas - Tom & Rory

Blue Dolphins - Martha & Ruby

Yellow Eagles - Zoe & Katy.



**FRIENDS OF ST GREGS.** The school relies heavily on the goodwill of local businesses, some of these goodwill champions are showcased on our school website. We are extremely grateful for their support. <https://stgregorymarnhull.dorset.sch.uk/friendsofstgregs/> If you feel your business or you personally can help the school in anyway please do get in touch.

**INTERESTED IN JOINING ST GREG'S?** We always welcome prospective families no matter the time of the year. Come and see first-hand what a wonderful place St Greg's is. Our website gives an insight into the school, but nothing compares to seeing and hearing our classes in action. <https://stgregorymarnhull.dorset.sch.uk/> Telephone - 01258 820206 Email - office@stgregorymarnhull.dorset.sch.uk

**SCHOOL FOR HIRE!** If anyone wishes to let our school hall, this can be arranged - contact the school office on 01258 820206 for all enquiries. Anyone who has attended the Zumba classes on a Wednesday will be familiar with the hall.



## ST MARY'S CATHOLIC PRIMARY SCHOOL



The new academic year at St Mary's started so well with a host of enthusiastic children and staff bursting through the gates every morning; however, as you are well aware the first week ended with the sad news of the death of Her Majesty Queen Elizabeth II. As a school, we prayed for her and the family at this sad time and remembered her extraordinary reign as our queen. The children had fond memories of celebrating her platinum Jubilee, and the younger children especially remembered her having tea with Paddington Bear. We thought it fitting to share this poem written by the much loved children's poet, Roger McGough published by The Poetry Society to mark the death of Her Majesty Queen Elizabeth II.



### God Rest the Queen

She spoke volumes quietly.  
Is everywhere and will remain so  
Our shared interest, our common currency  
The nation cannot let her go.

Stars untwinkle one by one  
The moon, in shock, averts its gaze  
No words express the grief we feel  
How we loved thee, let us count the ways.

The future, fearful, has gone awol  
Life goes on but not the one we know  
Though wreaths and words may wither  
The nation will not let her go.

Guns fall silent, the flag lowered  
She who kept us close is gone  
Winter is composing a sad anthem  
It will play on and on and on.

8th September 2022

### St Mary's Explorers Preschool

It has been wonderful welcoming back our preschoolers after their summer break. During the break, staff have spent time improving our classroom environment. Particular attention has been paid to making our role play area homely. The children have thoroughly enjoyed playing in this area taking on familiar roles.

We are looking forward to getting out and about this month and looking for Autumn treasures. It's always lovely to see the children's reactions to the beauty of nature. We plan to collect leaves, talk about their colours and create artwork with them. The children are anticipating collecting

conkers from our tree but we still need to be a little patient before the tree shares its treasures with us. Welly walks to the school nature area will provide lots of hands on experiences!

St Mary's Explorers is open from 8:45am - 3:15pm every week day during term time and spaces are available for children aged 3 years +, with wrap around care from 8am-6pm. If you would like to have a look around, or come and stay for a taster session, please call 01258 820417 to make an appointment.

### St Anthony's

The new academic year has started well with the welcome of new children and families to our school. The Reception children have settled quickly and are taking each new experience in their stride. They have enjoyed exploring their learning environment, getting reacquainted with old friends and making new ones. We are starting the year with a focus on the children themselves, what makes them unique and how they fit into their school community. The Year 1 children have been really helpful showing the younger children how the learning environment works and have bounced back to school eager to continue with their learning in familiar surroundings.

### St Mark's

The children have settled in to their new class with their new class teacher, they have been inspired by the 'Owl Who Was Afraid of the Dark' book for their writing; together they have been discovering why dark is good.

### St Francis'

The new year has started well with our new class getting to know each other and being inspired by Katherine Rundell's 'The Explorers', further developing their writing through some amazing alliteration and super similes.

### St Alban's

An enthusiastic start to the year in our new class has set the bar high for the remainder of the year! The children have been researching the life of Queen Elizabeth II to support them writing her biography.



### Do you have a child due to start school in September 2023?

With the deadline approaching for new parents to make choices on a school for their four year olds, we will be having some open mornings from 9:30 on 3rd October, 10th October, 17th October 2022 in addition to an 'open door' policy at school. Any prospective parents are welcome to call the school on 01258 820417 to organise a tour or just pop into the school office and ask to take a look around.

Our popular preschool also has spaces. We find that children who attend our preschool setting make a smooth transition into Reception, since they are familiar with the environment.



**AJS Plumbing & Heating**  
Plumbing & Heating Engineer

Tel: 01963 400503 or 07814 038852  
Email: [office@ajs-plumbingandheating.co.uk](mailto:office@ajs-plumbingandheating.co.uk)  
Website: [www.ajs-plumbingandheating.co.uk](http://www.ajs-plumbingandheating.co.uk)



Boiler Servicing & Maintenance  
Air Source Heat Pumps/Ground Source Heat Pumps  
Bathroom Installation Underfloor Heating  
General Plumbing  
Landlord Certificates & Power Flushing



**Yenstone Walling Ltd** 

Dry Stone Walling and Landscaping  
All types of stone walling undertaken

Patrick Houchen 01963 371123  
DSWA member 07791 588141  
CIS registered [www.yenstonewalling.co.uk](http://www.yenstonewalling.co.uk)



**BRAMALL GARDENS LTD**

*DESIGN—LANDSCAPING—MAINTENANCE*

EXPERIENCED IN ALL ASPECTS OF GARDENING

FAST AND EFFICIENT  
ALL RUBBISH REMOVED



☎ : 01258 820394 MOBILE : 07971 793 872

**Vale Electrics**

- New Installations
- Rewires
- Replacement Consumer units
- Condition Reports
- Fault Finding

Tel: 01258 821420 Mob: 07740403033  
Email: [valeelectrics@hotmail.co.uk](mailto:valeelectrics@hotmail.co.uk)  
8 Plowman Close, Marnhull, DT10 1LB



**Dorset Forge  
& Fabrication**

**Chris Hannam**

01935 50 82 81 - 07950 33 75 76

Elm Yard, Three Elms Inn, North Wootton  
Sherborne DT9 5JW

- Traditional and Contemporary Forge Work
- Design Service
- Gates and Railings
- Garden Architecture
- Balconies and Handrails
- Restoration
- Cast Iron Repair
- On-site Welding and Fabrication Service
- Shot Blasting and Painting Service
- Brick, Stone and Flintwork

[chris@dorsetforgeandfabrication.co.uk](mailto:chris@dorsetforgeandfabrication.co.uk)  
[www.dorsetforgeandfabrication.co.uk](http://www.dorsetforgeandfabrication.co.uk)



Providing competitive Property Maintenance Services for both residential and commercial properties to home owners, Letting agencies and Landlords throughout Dorset, Somerset and Wiltshire.

Services include:  
Painting & Decorating, Internal & External Property repairs,  
Kitchen and Bathroom re-modelling, House clearances

Revsol Property Services are also licensed waste carriers  
and undertake house clearances and deep cleans

For further information call Duncan on Main line: 01258 820870  
Mobile: 07966 016686 or Matt on 07483 822245  
email [revsol@outlook.com](mailto:revsol@outlook.com)



**CHAFFERS**  
ESTATE AGENTS

Incorporating



**ROY BARRETT**  
ESTATE AGENTS

Experts in local knowledge

**SALES, LETTINGS, COMMERCIAL, SURVEYS**

**More Properties Urgently Required!**

Gillingham \* Shaftesbury \* Sturminster Newton \* Wincanton

**Tel: 01258 473900**



**OAK DIGITAL SOLUTIONS**

**IT HELP AND TRAINING**

- Problem Solving for all your Technology
- Help with Software and Applications
- Wi-Fi Connections and Printers
- Friendly Patient Personal Training at Home
- Installation and Setup of Equipment
- Changing Batteries and Sim Cards
- Transferring Pictures, Documents and Files

Computers, Mobile Phones, Tablets, Laptops, Printers, Wi-Fi, Smart TVs, e-book readers etc.

**WEBSITE DESIGN**

Individual Website Design for Small Businesses  
Optimised for PC, Mobile Phones & Tablets  
Reliable Hosting & Top Level Security

Contact Chris: **07758 032062**  
oakdigitalsolutions@gmail.com  
www.oakdigitalsolutions.co.uk





**HOOK**

**ELECTRICAL CONTRACTORS**

**Domestic Commercial Ecclesiastical**

*All Aspects of Design, Installation, Inspections & Repair works*

Contact Ed Cudlip on **01258 820161** or **07956281644**  
Email: [hookelectrical@gmail.com](mailto:hookelectrical@gmail.com)





**LODESTONE**  
Property Sales, Lettings & Advice

lodestoneproperty.co.uk







**THE DORSET TRIO**  
**MAKING HOMES HAPPEN**

With over 200 years of property experience between us, our team have had plenty of practice opening new doors for clients.

Through our dedicated sales team, sales progressor, local specialist viewing agents and an online global reach of over 100,000 a month, we are well placed to make your next home happen.

Please call our Shaftesbury office if you would like further advice about the current market.







Simon Neville-Jones  
Branch Manager



Alison Cuff  
Sales Advisor



Rosa Clutterbuck  
Lettings Manager

bruton@lodestoneproperty.co.uk 01749 605099      shaftesbury@lodestoneproperty.co.uk 01747 442577      wells@lodestoneproperty.co.uk 01749 605088

# The Jungle Hut Pre School



We are a childcare setting providing care and education for children aged 2-4 years on the premises of St. Gregory's Primary School in Marnhull. We are open from 8.30am until 3.00pm for 38 weeks per year, on a term time only basis.

We are a community group, a company limited by guarantee and a registered charity.

For more information please visit our website: [www.thejunglehutpreschool.co.uk](http://www.thejunglehutpreschool.co.uk)

Or contact us on: **01258 820096** or at: [thejunglehutpreschool@hotmail.com](mailto:thejunglehutpreschool@hotmail.com)



## MARNHULL ENTERTAINS

in association with

**DORSET MOVIOLA**

### Operation Mincemeat (PG-13)

Marnhull Village Hall

Tuesday 25 October

at 7.30 pm

Doors open 7.00 pm

Tickets: £5.00

Available from:

Robin Hill Stores: 01258 820959 or Marnhull Stores: 01258 820116

#### Operation Mincemeat

It's 1943. The Allies are determined to break Hitler's grip on occupied Europe and plan an all-out assault on Sicily; but they face an impossible challenge - how to protect a massive invasion force from potential massacre.

It falls to two remarkable intelligence officers, Ewen Montagu and Charles Cholmondeley, to dream the most inspired and improbable disinformation strategy of the war - centred on the most unlikely of secret agents: a dead man.



**MARNHULL  
COMMUNITY CAFÉ**

**IS OPEN**

on the 3rd Friday each month

10-12 @ The Village Hall

The café is free so all welcome for coffee, cake and a chat

Supported by the Blackmore Vale Partnership



## Village Hall Supporters Club

---

### Have you renewed your annual subscription?

For just £10.00 per ticket, you could win a top prize of £150.00, a second prize of £100, or one of three £50 prizes. By buying a ticket you will also be helping support the continued refurbishment of the Village Hall.



The cost of one ticket is just £10, which will entitle the owner to be entered for four quarterly draws. To simplify the payments, we have introduced the option of bank transfer, as well as cheque or cash. You can join the Club at any time of the year. You will then be entered for the next Quarterly Draw, which will be on **30 September 2022**. Please complete the Application Form below and send either in the post or via email with your payment method to the Treasurer – details at the bottom of the form.

### Marnhull Village Hall Supporters Club APPLICATION FORM

I /We wish to become member(s) of the Supporters Club and purchase ..... tickets at £10.00 each per annum to be entered into the prize draws.

NAME ..... PHONE No .....

ADDRESS ..... POST CODE .....

..... EMAIL .....

#### PAYMENT METHOD

(1) BACS payment to: Marnhull Village Hall, Sort Code 30-90-92, Account No 00622645

Please use SUPPORTERS CLUB as the Payees reference

(2) By Cheque payable to MARNHULL VILLAGE HALL

(3) By Cash

Signature ..... Date ...../...../ 2021

**Please return your application form to: Rob Norton, Treasurer, Marnhull Village Hall, The Retreat, New Street, Marnhull, DT10 1QA. If you are paying online you can scan or photograph your application form and Email to: [treasurer@marnhullvillagehall.org.uk](mailto:treasurer@marnhullvillagehall.org.uk)**

**ARO CLEANING SERVICES  
FOR CARPETS & OVENS**



**Quotations are FREE**  
info@aroservicesltd.co.uk

**Contact Andy  
07507 779000**

**Jill Cook**  
Counsellor  
BACP Senior Accredited  
www.jillcook.co.uk

I offer support for issues including anxiety, depression, relationship difficulties & bereavement.

For more information please contact me

07944 669416  
Marnhull & Milborne Port

**Boilerwise Ltd**  
**Specialist Boiler Engineers**

Repair, Service, Maintenance and Replacement of OIL and GAS Boilers. Heating System Fault Diagnosis and Repair. Landlord Certificates, Systems Surveying and Power Flushing.

**01258 474605**  
24hr Gas Safe and Oftec Registered Engineers



©LLW

**TAXI – CAR**



*Courteous Lady Driver*  
Tel: 01258 820526  
Mobile: 07929 983095



www.sjcltd.co.uk    01258 471669    enquiries@sjcltd.co.uk

**Simon John Christopher Ltd**  
Chartered Accountant & Tax Consultants



**Accounts Preparation**  
**Self Assessment Tax Returns**  
**Tax Consultancy**

Drapers House, Market Place,  
Sturminster Newton, DT10 1AS

**The  
Curtain  
Man**



Curtains ~ Blinds  
Carpets ~ Vinyls  
Tracks ~ Poles  
Fabrics ~ Cushions  
Measuring & Fitting Service

Burton Street, Marnhull, Sturminster Newton,  
Dorset. DT10 1PH  
T: 01258 821117  
E: thecurtainmanshop@gmail.com

# TREAT YOUR FEET!

Julie Anne Smith  
DpodM MRCPod  
**PODIATRIST**

**01258 821297**

Burton Street, Marnhull,  
DT10 1PS  
stedmundspodiatry@gmail.com



R&S

## LEWIS JOINERY

Purpose made fitted wardrobes  
bookcases, cupboards,  
hardwood windows,  
doors & gates.  
lewisjoinery@hotmail.com  
01258 820467  
Workshop 01963 363862

## PLUMBWOOD

For all domestic plumbing repairs:  
taps, toilets, radiators, showers  
etc – no job too small.

*Woodwork projects also  
undertaken*

Call Tim and Helen Cronin  
01258 820520/07780 673053

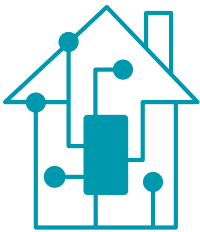

4 Musbury Close,  
Marnhull

## Ben Hannam Electrical Contractor

All aspects of electrical work undertaken

- New installations and rewires
- Alterations and additions
- Consumer unit (fuseboard) upgrades
- Fault finding and repairs
- Condition reports
- Heating controls and systems



Tel: 01258 808 329 • Mobile: 07914 760 295 • Email: [benhannamelectrical@gmail.com](mailto:benhannamelectrical@gmail.com)



Renovations • Extensions • New Builds  
Conservation Works • Listed Works  
Loft Conversions • Property Maintenance  
Kitchen & Bathroom Installation

Tel: 01963 363002 Mob: 07886 957385  
[www.regencyrenovations.co.uk](http://www.regencyrenovations.co.uk)

## R.M. MOGRIDGE CONTRACTING LTD

*For All Your Construction Needs*

- Commercial • Domestic • Agricultural • Equestrian
- Excavation • Ground Clearance • Spoils Disposal • Foundations
- Drainage • Septic Tanks • Concreting • Tarmacing • Paving
- Oversites • Driveways • Kerbing • Ponds • Lakes • Synthetic Lining

**For Advice & Free Quotations**

**Tel. 01963 363208 or 07836 747895**

**E.mail: [rmmogridgecontractingltd@btconnect.com](mailto:rmmogridgecontractingltd@btconnect.com)**

## LITTERPICKERS

Help us keeping Marnhull village and  
surrounding roads litter free.

Join our band of volunteers,  
contact John Seear on 01258 269743



## Have you moved here since October 2021? If so, we need to hear from you?

For a number of years Marnhull Village Care has welcomed new people to the village by holding a Social Evening with this year's event falling on Friday 30<sup>th</sup> September so with that in mind we would like you to contact us with the following information.

Names of all those in your household

Address

Contact telephone number.

Email Address.

So, we can send you an invitation and arrange refreshments to this most prestigious event. Please send details or contact our Administrator as follows.

Ms Hilary Parker 01258 821667 Email hilaryparker85@gmail.com

Kind regards,

*Trevor Vaughan*

Trevor Vaughan. MBE

Chairman Marnhull Village Care

Do you need help with shopping, going to hospital or dentist for treatment or visiting a relation, feel lonely, just want a chat or some company for an hour or so? Whatever is of concern to you and you live in Marnhull, Marnhull Village Care can help, we have a number of volunteers and professional people that are available all you have to do is ring any of the following numbers.

Car journeys Mrs Ann Davis - Penson 07434 638485  
Anything else Hilary Parker 01258 821667  
or Trevor Vaughan 07796443832 / 01258 821636

**You are not alone - we are here to help.  
Phone us or email: [trevor.mpc@gmail.com](mailto:trevor.mpc@gmail.com).**



**Walk for Wards at Wilton House**  
**Sunday 3rd July 2022**

**FREE to Enter**  
(Subject to a minimum sponsorship of £20 per person)

**FREE Lunch**

**FREE Entry to the Wilton House gardens**

**CHOICE of routes: 3k, 5k or 10k**

**Walk for the Ward or Department of your choice**

Register free at [www.starsappeal.org](http://www.starsappeal.org)

Limited places available - advanced registration only. Closing date 28th June

Principal sponsor: **reds**

Supported by: **WILTON HOUSE unstuckdesign Salisbury Journal** and **SIMON WARD**

**Friars Moor Vets**

Friars Moor Veterinary Clinic is a professional, dedicated and friendly team providing excellent care in the best interests of you and your pets.

**24 Hour Emergency Care Consultations by appointment**

Sturminster: **01258 472314**  
Shaftesbury: **01747 850500**  
Blandford: **01258 472160**

RCVS ACCREDITED PRACTICE | LIKE US ON facebook | XL Pets

[www.friarsmoorvets.co.uk](http://www.friarsmoorvets.co.uk)







## 'Rustic Farm Shop on our farm in Marnhull'

- Great variety of tasty local products.
- Wide selection of local meat and game including our own meat, and personalised meat orders.
- Takeaway bacon rolls, hot drinks and cream teas.
- Good selection of big bag dog foods.
- Local Cider and beer.
- Individualised Hampers and treat bundles for any celebrations or Birthdays.
- Gift Vouchers



Why not pop in? Open 10am to 3pm.  
Mon, Tues, Thurs, Fri & Sat  
DT10 1QG

Or ring/text 07866 984323 | Email [maria-robinson40@yahoo.co.uk](mailto:maria-robinson40@yahoo.co.uk)  



## CLOCK HOUSE Bed & Breakfast

Burton Street, Marnhull

Charming, peaceful, tucked away B&B in the centre of the village. Clock House offers four ground floor, ensuite bedrooms with terrace and garden access and a guest living room with woodburning stove. Dog friendly.

**Discounted rate for Marnhull villagers booking direct.**



Telephone: 01258 820645  
[info@clockhouse-marnhull.com](mailto:info@clockhouse-marnhull.com)  
[www.clockhouse-marnhull.com](http://www.clockhouse-marnhull.com)

## WORD of MOUTH HOME IMPROVEMENTS

PROFESSIONAL, RELIABLE, LOCAL

- Painting – interior/exterior
- Decorating
- General building maintenance
- Guttering – clearing/replacing
- Roof repairs
- Bricklaying
- Re-pointing
- Carpentry
- Tiling
- Paving
- Window replacement/installation

Please call Andy for a free quote

# Mobile 07939 196384

Email: [yaffle1@hotmail.co.uk](mailto:yaffle1@hotmail.co.uk)

[www.Back2Market.com](http://www.Back2Market.com)

REMOVALS - PACKING - STORAGE - CLEARANCE



Contact us for your free, no obligation quote

Phone: 01963 400352

Freephone: 0800 2425012

Mobile: 07853 275379

Email: [enquiries@back2market.com](mailto:enquiries@back2market.com)

Website: [www.back2market.com](http://www.back2market.com)

**BARTLETT  
CONTRACTORS LTD**

**AGRICULTURAL CONTRACTORS**  
COMPLETE AGRICULTURAL CONTRACTING SERVICE

**CIVIL ENGINEERS: HEAVY AND RURAL**  
OPERATED PLANT HIRE, HAULAGE, LANDSCAPING, FENCING,  
LAND DRAINAGE, HEDGE TRIMMING,  
LAKE AND POND CONSTRUCTION

**TRACK REGENERATION**  
POTHoles TAKEN OUT IN ONE PASS,  
QUARTER THE PRICE OF RESTONING THE SURFACE. CEMENT  
CAN BE INCORPORATED



SUPPLIERS OF OOLITIC LIMESTONE, TURF, TOPSOIL,  
SAND, GRAVEL, SCALPINGS AND MORE

**01258 472419**

Web: [www.bartlettcontractors.co.uk](http://www.bartlettcontractors.co.uk)

For more information please visit:  
[www.marnhullstone.co.uk](http://www.marnhullstone.co.uk)



*SUPPLIERS OF NATURAL AND CUT STONE:*

*RANDOM DRESSED  
SAWN SPLIT  
CHISEL FACED ASHLAR  
WINDOW SURROUNDS  
DECORATIVE WALLS*



FIREPLACES

ASHLAR

FLOORING

Dean Harris (Quarry Manager): 07771 684647  
Office: 01258 472419  
Whiteway Quarry, Whiteway Lane, Marnhull,  
Dorset, DT10 1NQ

**TONY WILLIAMS  
ACCIDENT REPAIRS**



**MIRACLE PULL - DENT REPAIRS**

APPROVED BY:



**LOCATED BETWEEN MARNHULL & STALBRIDGE**  
**01963 365733**

**OFFERING THE HIGHEST QUALITY REPAIRS USING THE BEST QUALITY  
MATERIALS & EQUIPMENT**





# ROBIN HILL STORES

POST OFFICE & CONVENIENCE STORE



- Beautiful Fresh Fruit & Veg
- Locally sourced hand carved ham & cheeses
- Fresh snacks & sandwiches
- Locally baked speciality breads & cakes
- Newspapers & Magazines
- Cards, Stationery
- Wines, Beers & Spirits
- A big range of household essentials

Full Post Office service including cheques & cash, car tax, electricity, gas & mobile top up. National Lottery, Foreign currency & Dry Cleaning



FREE home delivery available

01258 820959 | robinhillstores@gmail.com | www.robinhillstores.co.uk  
Mon – Saturday 7.30 til 8 Sunday 7.30 til 12



Love your Local Shop,  
**THINK BIG, SHOP SMALL**



## New Inn Farmhouse & Barn



5 Star Holiday let & B&B

Consisting of 8 Bedroom (5 ensuite), games room, & Hot tubs

Located in the beautiful Dorset Village of Marnhull



Contact: newinnfarmhouse@outlook.com

Tel: 07966 016686

Or visit: newinnfarmhouse.co.uk



All aspects of building work undertaken including:

- **Extensions**
- **New Builds**
- **Roofing**
- **Renovations**
- **Loft Conversions**

Camelot Builders Ltd  
Farm Office  
East Lawn Farm  
Lawn Crossroads  
Gillingham  
Dorset SP8 5QN  
www.camelotbuilders.co.uk

Tel: 01747 835422

email: info@camelotbuilders.co.uk





## BADMINTON FOR BEGINNERS

Monday club social night: 8–10pm (except bank holidays)  
 £25 Joining Fee  
 Adults £4.50  
 Family £7.00 (up to 2 adults & 2 children)  
 Juniors £3.00

ALL COACHING FREE (Badminton England Coach)  
 Loads of fun for children and families

## BADMINTON CLUB NIGHT

Tuesday club night: 7.00–10.00pm  
 First night free to new members

ALL COACHING FREE (Badminton England Coach)  
 Intermediate level players always welcome

## BADMINTON SENIOR NIGHT

Thursday senior league night: 8.15-10.15pm  
 The club is interested in players who wish to play at a league level.

The club participates in the salisbury district league – div2 mens and div2 mixed and div3 mixed

Contact: Robert Tulk - 01258 820728

Meet at Riversmeet on Mondays, Tuesdays & Thursdays

## FRENCH & SPANISH CONVERSATION

Want to get those little grey cells working? Then come along to French or

Spanish conversation! This can complement your work with Duolingo or refresh your memories of your O level days. For more information contact

Ros Eveleigh on 821049.

## FIX DON'T THROW

The team at Dorset Tech have been training with specialist micro-soldering techniques and will soon be able to do levels of tech repairs that are not offered in the area.

This large investment in high-end microscopes, hot air stations and Apple accreditation will allow us to save even more devices from becoming e-waste. We're encouraging residents of Marnhull to "Fix don't throw". Something as simple as a battery replacement can make an old phone feel like a new one.

Currently our repairs are carried out at our high street branch in Gillingham, but we're investigating having pop-up tech help sessions in the village. We'd love to have your feedback on this.

For more information visit [dorset.tech](http://dorset.tech) or call 01258 808577.

## MARNHULL CRAFT CLUB

Meets at 10:00am on the first Thursday of every month (except August) in

**The Methodist Church Hall**

Relax, meet new and old friends for coffee and chat. Use your skills and learn something new, in a friendly and relaxed atmosphere.

More information from Allison Palmer - 07810464630

## MARNHULL BRIDGE CLUB

Marnhull Bridge Club meets in the Methodist Hall every Tuesday at 2pm to play Chicago.

New Players always welcome.

Call 01258 820036 for information

## MARNHULL GARDEN CLUB

The Garden Club meets at 7.30pm on the 2nd Tuesday of the most months, in Marnhull Village Hall.

Come and join us for refreshments and a chat. We usually have a guest speaker and learn some new gardening tips.

For further details contact Dave Bruce (Chair) on [Bruce11@sky.com](mailto:Bruce11@sky.com)

# New Messenger Deadline: 14th October

E-mail all texts, announcements and other requests to: [editor@marnhullmessenger.org.uk](mailto:editor@marnhullmessenger.org.uk)

## CROSSWORD AND SUDOKU ANSWERS

8	7	1	2	4	9	5	6	3	8	2	1	6	3	7	5	4	9	
2	5	6	4	7	9	1	8	3	9	7	5	4	2	8	6	1	3	
7	1	5	3	6	8	9	4	2	3	1	9	7	8	2	4	5	6	
3	9	2	2	4	5	7	6	1	8	7	8	2	5	6	4	9	3	1
4	8	6	9	2	1	7	3	5	5	6	4	3	9	1	8	2	7	
5	2	7	8	1	4	3	9	6	1	4	9	8	2	7	5	4	6	
1	4	9	6	3	5	2	8	7	6	3	8	8	7	9	2	1	5	4
9	6	4	5	7	3	8	2	1	9	7	5	4	2	8	6	1	3	
2	5	3	1	8	6	4	7	9	4	3	6	9	1	5	2	7	8	
8	7	1	2	4	9	5	6	3	8	2	1	6	3	7	5	4	9	

- ACROSS** 1. Bushel 4. Major 6. Dee 7. Anaconda 8. Lead 11. Irene 13. Oast 15. Scrooge 16. Arabian 17. Idle 19. Snowy 21. Wham 24. Compound 25. Gig 26. Lorna 27. Dry ice.
- DOWN** 1. Bella 2. Huntingdon 3. Lucre 4. Minke 5. Joanna 6. Dail 9. El CID 10. Doone 12. Necromancy 13. Oxbow 14. SSAFA 18. Lancer 19. Samba 20. Ovoid 22. Henge 23. Ming



*From Design to Reality*



Products range from **conservatories, extensions, loft conversions, alterations, new properties, natural stone** etc. Based in Sturminster Newton, between Shaftesbury and Blandford, we cover Dorset, Wiltshire, Somerset, Hampshire and beyond.

Calcott Construction is a building contractor who has been established since 1984 and handles all types of home improvements from conservatories to new dwellings. We provide a personal hands on service on all projects large and small. We always have a regular team of friendly and experienced tradespeople to complete all projects to the highest standard.

We are able to assist you in the design process right through to the reality of a completed project with the aid of an architect.

**Conservatories Extensions Loft Conversions Alterations New Properties Natural Stone Dry Stone Walling**

**T: 01258 475 046**  
**www.calcottconstruction.co.uk**



**COMPTON  
SMITH**  
INTERIORS

**www.comptonsmith.co.uk**

FULL INTERIOR DESIGN SERVICE

- Interior decorating consultancy.
- Bespoke curtains, blinds and upholstery.
- Suppliers of well-known specialist paints, wallpapers & fabrics:  
*Farrow & Ball, Little Greene, Pierre Frey, Colefax & Fowler, Lewis and Wood, Sanderson Design Group and many more designers.*

**Monday to Friday: 8.30am - 5.30pm**

**Saturday: 9.30am - 1.00pm**

10d Wincombe Business Park,  
Shaftesbury, Dorset SP7 9QJ

**Tel: +44 (0)1747 850150**

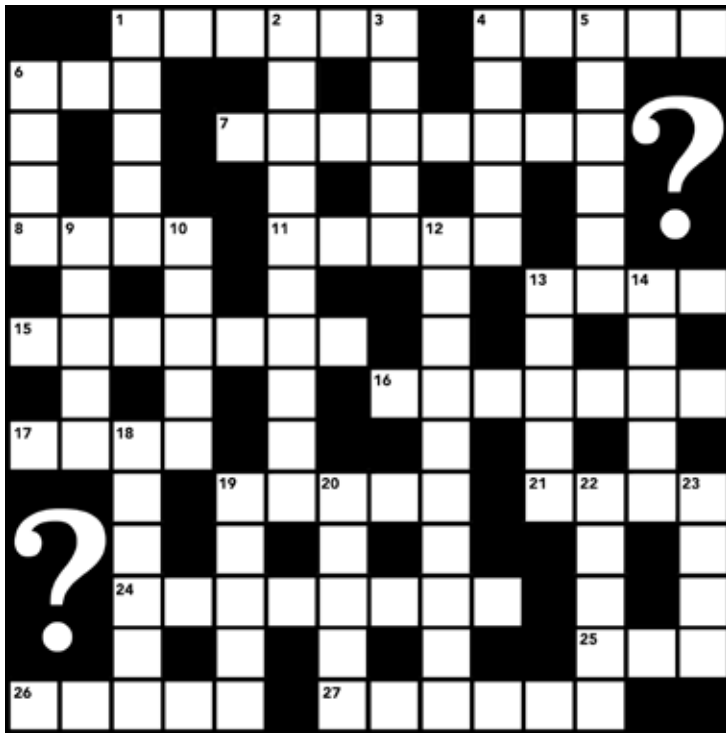

## ACROSS

- 1) Measure of capacity equal to 8 gallons. (6)
- 4) One of the four most prestigious professional golf tournaments. (5)
- 6) River that rises in Snowdonia and runs 70 miles through Chester to the Wirral peninsular. (3)
- 7) Large snake of South America. (8)
- 8) Metal with the chemical symbol Pb. (4)
- 11) Female name taken from the Greek goddess of peace. (5)
- 13) Kiln for drying hops. (4)
- 15) Dickens' character whose name has come to mean a miserly person. (7)
- 16) Sea that is a region of the Northern Indian Ocean bounded on the north by Pakistan and Iran. (7)
- 17) Eric former member of the Monty Python comedy group. (4)
- 19) Owl of the Arctic tundra. (5)
- 21) Pop duo who got to number one in January 2021 with a track first recorded in 1984. (4)
- 24) A thing composed of two or three elements. (8)
- 25) Short for a unit of information in computing. (3)
- 26) and 10D) Titular character in a book by R. D. Blackmore set on Exmoor. (5)
- 27) White mist produced with solid carbon dioxide as a theatrical effect. (6)

## DOWN

- 1) Italian name meaning beautiful. (5)
- 2) Cambridgeshire town for which Oliver Cromwell and John Major have been the MP. (10)
- 3) Money especially dishonourably obtained. (5)
- 4) Small whale species. (5)
- 5) Female name used as cockney rhyming slang for a piano. (6)
- 6) Lower house of Parliament in the Republic of Ireland. (4)
- 9) National icon of Spain whose name means 'The Lord'. (2-3)
- 10) See 26A).
- 12) Communicating with the dead to predict the future. (10)
- 13) Loop formed by a horseshoe bend in a river. (5)
- 14) Military charity known by an acronym of its name. (5)
- 18) A cavalryman. (6)
- 19) Brazilian dance. (5)
- 20) Egg shaped. (5)
- 22) Neolithic stone or wood circle. (5)
- 23) Arch enemy of Flash Gordon. (4)

				5	
3	6	9		2	7
7				6	
3				2	
			9		7
8	2	6	4		3
9		4		7	5
6		2	7		9

		2		9	5	
	5	3			4	
9						
6					1	4
			3		2	8
5		8			3	9
4			2			
3	2	4	5		6	
				8		

### MARNHULL TABLE TENNIS

Monday & Wednesday afternoons  
 Now playing within Covid restrictions  
 Come and try us!!  
 Contact: Boyd Sofield - 01258 820964 or  
 John Dowsett - john.dowsett@virgin.net

### MARNHULL WOMEN'S INSTITUTE

Meets on the 2nd Monday in the month (except Aug)  
 At 7.30pm in the Village Hall  
 We look forward to seeing new and old members  
 President: Nicola Denham - 01258 821343

### BLACKMORE VALE ART GROUP

The group meets monthly on the second Friday at  
 10:30am in the Village Hall.  
 All styles and levels of experience are welcomed.  
 For further information contact Yvonne 820247 or  
 mikyon@aol.com

**All PUZZLE ANSWERS ON  
 PAGE 28**



a fresh approach

- ◆ Buying and Selling Your Home
- ◆ Wills
- ◆ Powers of Attorney
- ◆ Probate and Estates
- ◆ Equity Release
- ◆ Commercial Property
- ◆ Agricultural and Rural Business
- ◆ Employment
- ◆ Property and Land Disputes
- ◆ Court of Protection



**MacLachlan**  
SOLICITORS

Shaftesbury: 01747 440448  
Sherborne: 01935 817736  
Gillingham: 01747 822103

[www.maclachlansolicitors.co.uk](http://www.maclachlansolicitors.co.uk)

**PITMANS®**



- Removals & Containerised Storage
- Partloads / Small Moves (Starting at £300+VAT)
- Shipping - Worldwide
- Local & Nationwide

**01258 858564**

[www.pitmansremovals.co.uk](http://www.pitmansremovals.co.uk)



 **Karndean**  
Designflooring  
Commercial Distributor

*Bespoke style with a price to make you smile.*

SH  P  
LOCAL

